



Floor 1



Floor 2

Approximate total area⁽¹⁾

318.9 m²

Reduced headroom

5.71 m²

(1) Excluding balconies and terraces

 Reduced headroom
(below 1.5m/4.92ft)

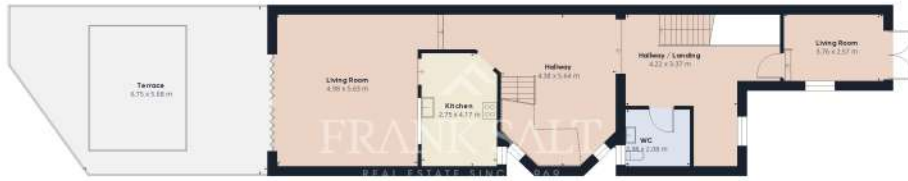

Floor 3

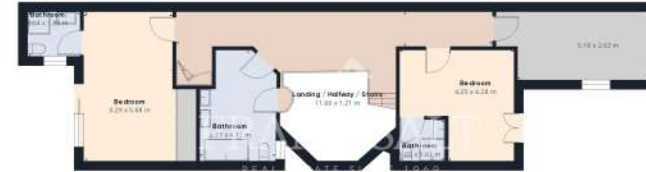

Floor 4



Floor 5



Garage
27.78 x 5.03 m



Approximate total area⁽¹⁾
100.81 m²

(1) Excluding balconies and terraces

While every attempt has been made to ensure accuracy, all measurements are approximate, not to scale. This floor plan is for illustrative purposes only.



Approximate total area⁽¹⁾

99.02 m²

Reduced headroom

5.09 m²

(1) Excluding balconies and terraces

Reduced headroom
(below 1.5m/4.92ft)

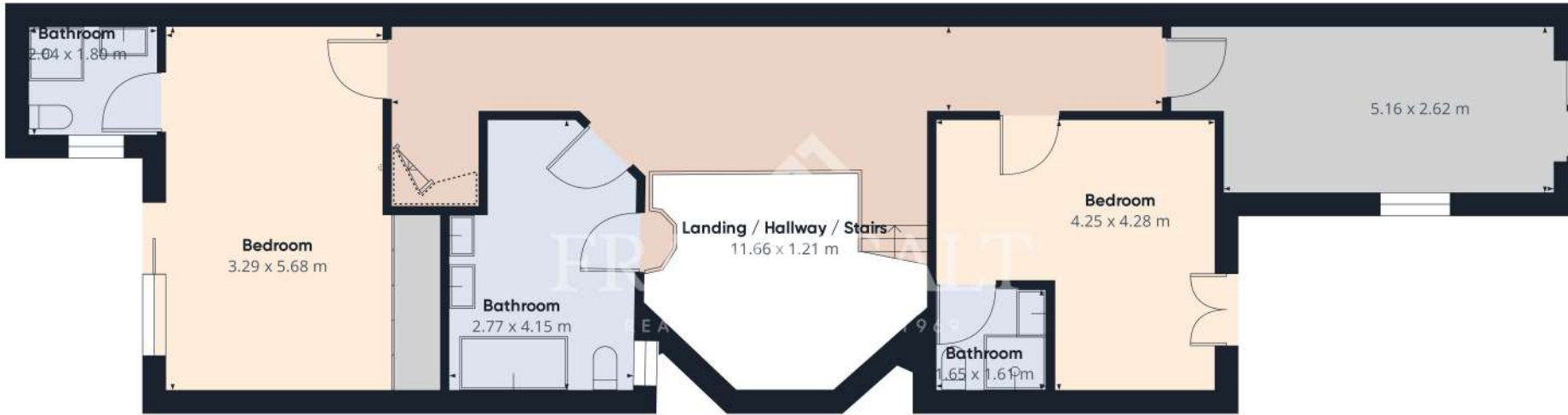

Approximate total area⁽¹⁾

90.95 m²

Reduced headroom

0.62 m²

(1) Excluding balconies and terraces

⊞ Reduced headroom
(below 1.5m/4.92ft)



Approximate total area⁽¹⁾
28.12 m²

(1) Excluding balconies and terraces